

BA847 TRANSISTOR (NPN)

FEATURES

- Ideally suited for automatic insertion
- For switching and AF amplifier applications

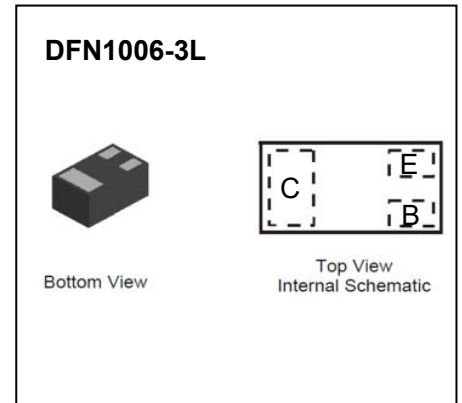

MARKING:

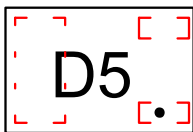

Front side

D5= Device code Solid
dot=Pin1 indicator

MAXIMUM RATINGS (T_a=25°C unless otherwise noted)

Symbol	Parameter	Value	Unit
V _{CB0}	Collector-Base Voltage	50	V
V _{CEO}	Collector-Emitter Voltage	45	V
V _{EBO}	Emitter-Base Voltage	6	V
I _C	Collector Current –Continuous	0.1	A
P _C	Collector Power Dissipation	275	mW
R _{θJA}	Thermal Resistance From Junction To Ambient	455	°C/W
T _J , T _{stg}	Operation Junction and Storage Temperature Range	-55~+150	°C

ELECTRICAL CHARACTERISTICS (T_a=25°C unless otherwise specified)

Parameter	Symbol	Test conditions	Min	Typ	Max	Unit
Collector-base breakdown voltage	V _{CB0}	I _C = 10μA, I _E =0	50			V
Collector-emitter breakdown voltage	V _{CEO}	I _C = 10mA, I _B =0	45			V
Emitter-base breakdown voltage	V _{EBO}	I _E = 10μA, I _C =0	6			V
Collector cut-off current	I _{CB0}	V _{CB} = 50V, I _E =0			0.1	μA
Emitter cut-off current	I _{EBO}	V _{EB} = 5V, I _C =0			0.1	μA
DC current gain	h _{FE}	V _{CE} = 5V, I _C = 2mA	220		475	
Collector-emitter saturation voltage	V _{CE(sat)}	I _C =100mA, I _B = 5mA			0.5	V
Base-emitter saturation voltage	V _{BE(sat)}	I _C =100mA, I _B = 5mA			1.1	V
Transition frequency	f _T	V _{CE} = 5V, I _C = 10mA f=100MHz	100			MHz
Collector output capacitance	C _{ob}	V _{CB} =10V, f=1MHz			4.5	pF

Typical Characteristics

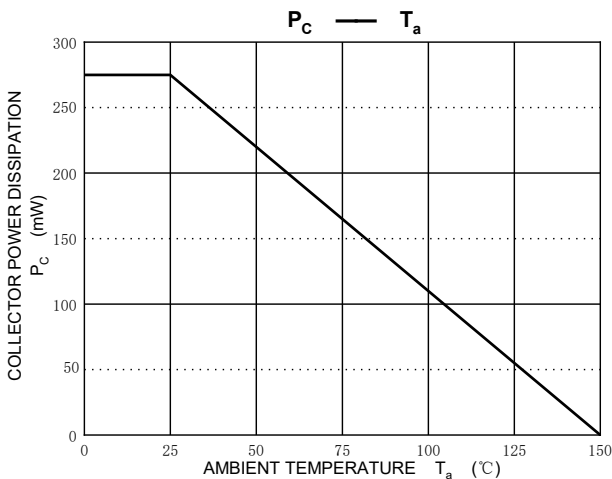
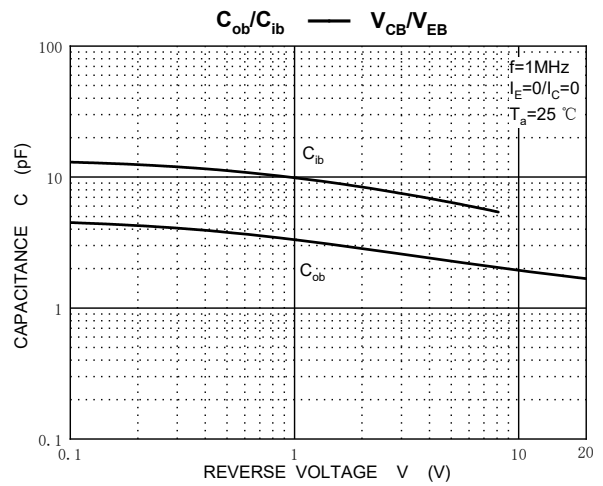
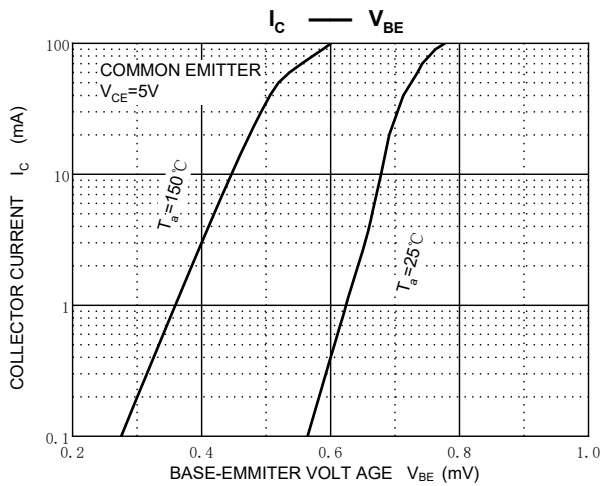
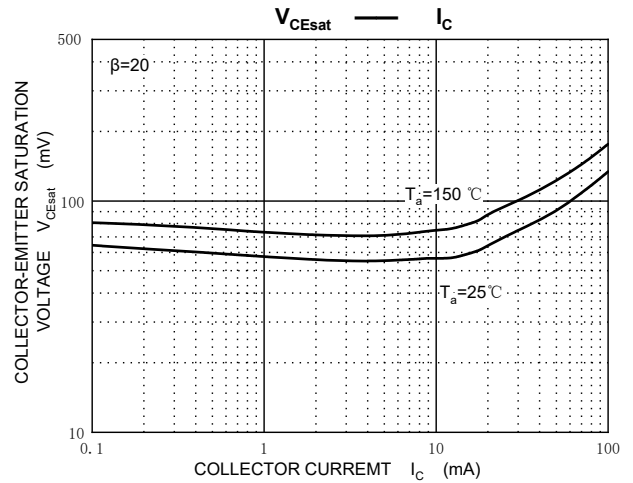
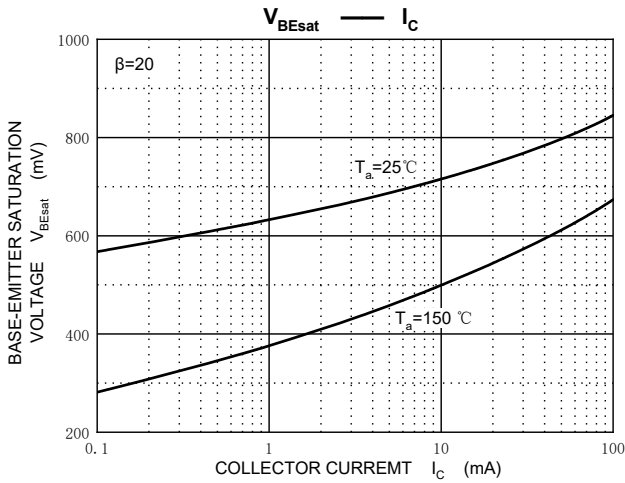
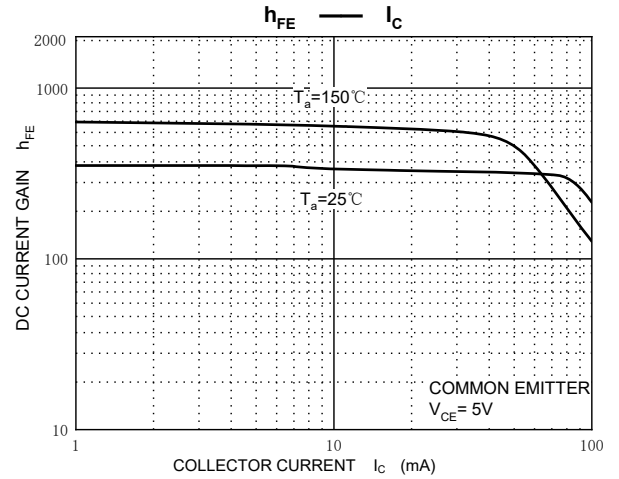
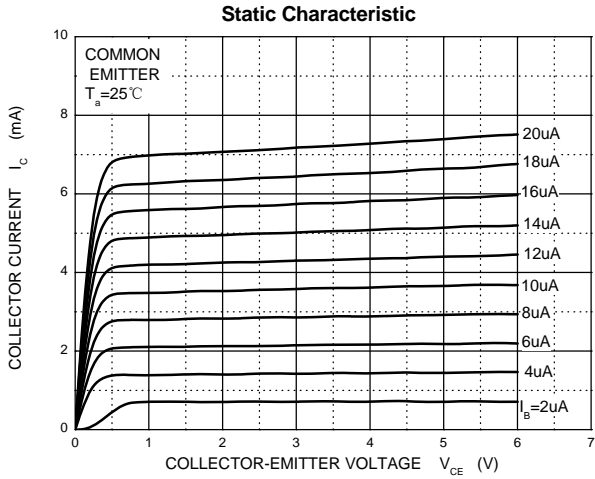

DFN1006-3L Package Outline Dimensions

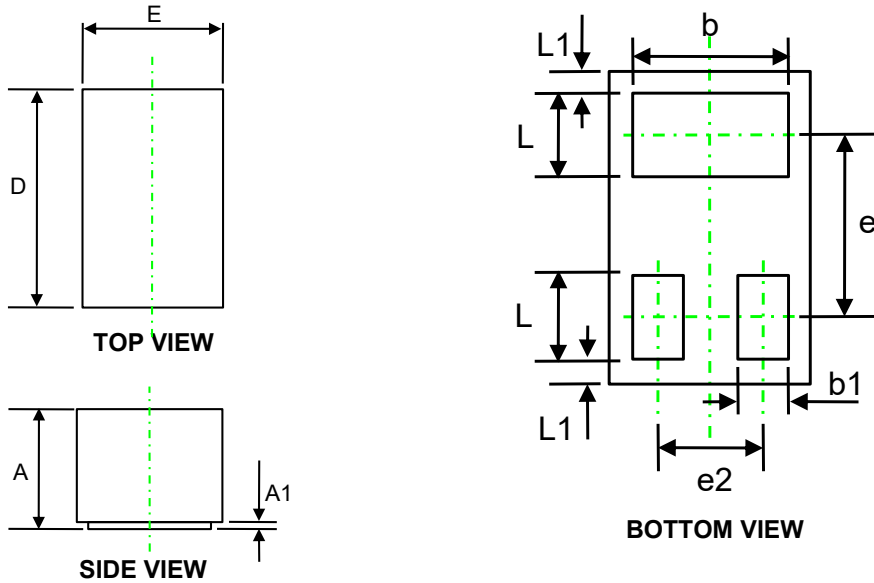

Symbol	Dimensions In Millimeters		Dimensions In Inches	
	Min.	Max.	Min.	Max.
A	0.400	0.500	0.016	0.020
A1	0.000	0.050	0.000	0.002
D	0.950	1.050	0.037	0.041
E	0.550	0.650	0.022	0.026
b	0.450	0.550	0.018	0.022
e	0.650 REF.		0.026 REF.	
e2	0.350 REF.		0.014 REF.	
L1	0.050 REF.		0.002 REF.	
L	0.200	0.300	0.008	0.012
b1	0.100	0.200	0.004	0.008

DFN1006-3L Suggested Pad Layout

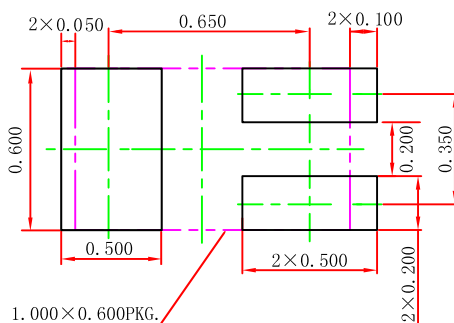

Note:

1. Controlling dimension: in millimeters.
2. General tolerance: ± 0.050 mm.
3. The pad layout is for reference purposes only.

NOTICE

JSCJ reserves the right to make modifications, enhancements, improvements, corrections or other changes without further notice to any product herein. JSCJ does not assume any liability arising out of the application or use of any product described herein.

DFN1006-3L Tape and Reel

DFN1006-3L Embossed Carrier Tape

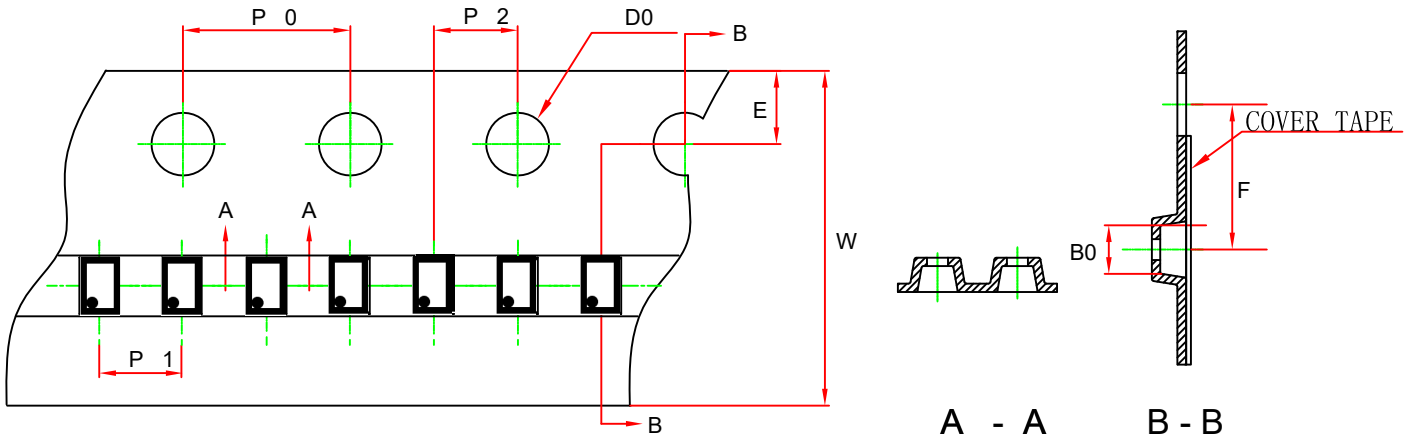

Dimensions In Millimeters (mm)								
Pkg type	B0	P0	P1	P2	E	F	W	D0
DFN1006-3L	1.11	4.00	2.00	2.00	1.75	3.50	8.00	1.55
Tolerance	+/-0.06	+/-0.1	+/-0.1	+/-0.1	+/-0.1	+/-0.1	+/-0.3	+/-0.1

DFN1006-3L Tape Leader and Trailer

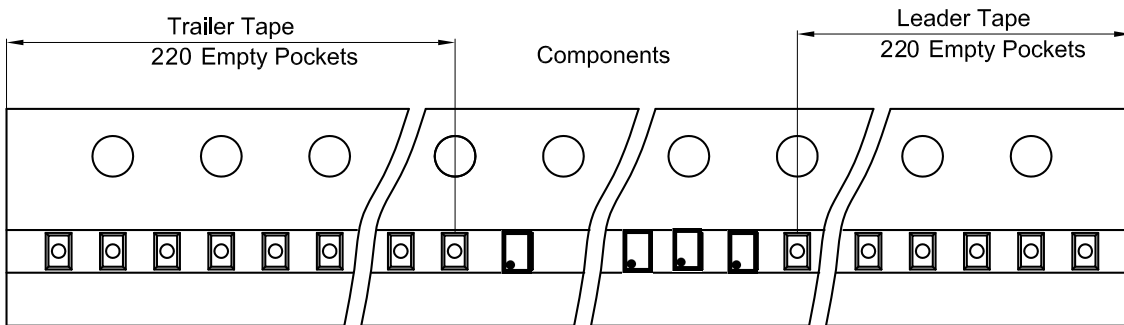

DFN1006-3L Reel

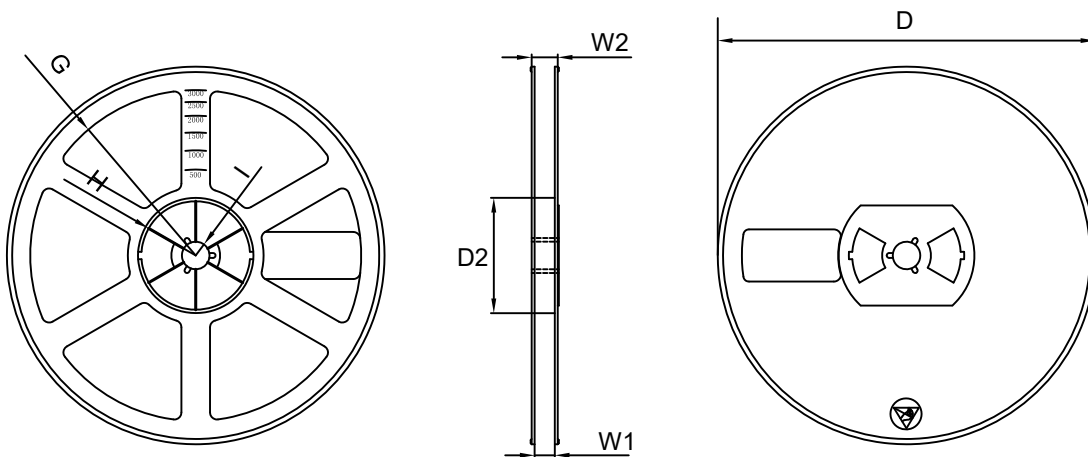

Symbol	Dimensions In Millimeters (mm)						
	D	D2	G	H	I	W1	W2
7" Dia	Φ178.00	54.50	R78.00	R25.6	R6.5	9.50	12.30
Tolerance	+/-2	+/-1	+/-1	+/-1	+/-1	+/-2	+/-1.5

REEL	Reel Size	Box	Box size(mm)	Carton	Carton Size(mm)
10000 pcs	7 inch	150000 pcs	220×220×210	600000 pcs	450×450×240