

## SOT-23 Plastic-Encapsulate MOSFETS

### CJ3139KA P-Channel MOSFET

$V_{(BR)DSS}$	$R_{DS(on)}$ TYP	$I_D$
-20V	330mΩ@-4.5V	-0.66A
	430mΩ@-2.5V	
	600mΩ@-1.8V	

#### SOT-23

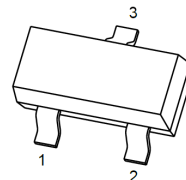

1. GATE
2. SOURCE
3. DRAIN

#### FEATURE

- Lead Free Product is Acquired
- Surface Mount Package
- P-Channel Switch with Low  $R_{DS(on)}$
- Operated at Low Logic Level Gate Drive

#### APPLICATIONS

- Load/Power Switching
- Interfacing, Logic Switching
- Battery Management for Ultra Small Portable Electronics

#### MARKING

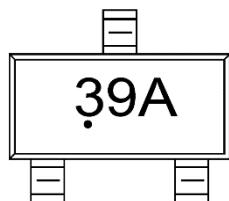

#### EQUIVALENT CIRCUIT

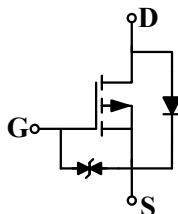

#### Maximum ratings ( $T_a=25^{\circ}\text{C}$ unless otherwise noted )

Parameter	Symbol	Limit	Unit
Drain-Source Voltage	$V_{DS}$	-20	V
Typical Gate-Source Voltage	$V_{GS}$	$\pm 10$	V
Continuous Drain Current	$I_D^{(1)}$	-0.66	A
Pulsed Drain Current	$I_{DM}^{(2)}$	-2.64	A
Power Dissipation	$P_D^{(5)}$	350	mW
Thermal Resistance from Junction to Ambient	$R_{\theta JA}^{(5)}$	357	$^{\circ}\text{C/W}$
Operating Junction and Storage Temperature Range	$T_J, T_{stg}$	-55~+150	$^{\circ}\text{C}$
Lead Temperature for Soldering Purposes(1/8" from case for 10 s)	$T_L$	260	$^{\circ}\text{C}$

# MOSFET ELECTRICAL CHARACTERISTICS

$T_J=25^{\circ}\text{C}$  unless otherwise specified

Parameter	Symbol	Test Condition	Min	Typ	Max	Unit
<b>STATIC CHARACTERISTICS</b>						
Drain-source breakdown voltage	$V_{(BR)DSS}$	$V_{GS} = 0V, I_D = -250\mu A$	-20			V
Zero gate voltage drain current	$I_{DSS}$	$V_{DS} = -20V, V_{GS} = 0V$			-1	$\mu A$
Gate-body leakage current	$I_{GSS}$	$V_{GS} = \pm 10V, V_{DS} = 0V$			$\pm 20$	$\mu A$
Gate-threshold voltage	$V_{GS(th)}$	$V_{DS} = V_{GS}, I_D = -250\mu A$	-0.35	-0.7	-1.1	V
Drain-source on-resistance	$R_{DS(on)}^{\text{③}}$	$V_{GS} = -4.5V, I_D = -1A$		330	450	$m\Omega$
		$V_{GS} = -2.5V, I_D = -0.8A$		430	600	$m\Omega$
		$V_{GS} = -1.8V, I_D = -0.5A$		600		$m\Omega$
Forward transconductance (note 2)	$g_{FS}^{\text{③}}$	$V_{DS} = -3V, I_D = -0.54A$		2.0		S
Diode forward voltage	$V_{SD}^{\text{③}}$	$I_S = -0.5A, V_{GS} = 0V$			-1.2	V
<b>DYNAMIC CHARACTERISTICS<sup>④</sup></b>						
Input capacitance	$C_{iss}$	$V_{DS} = -16V, V_{GS} = 0V,$ $f = 1MHz$		60		$\mu F$
Output capacitance	$C_{oss}$			12		
Reverse transfer capacitance	$C_{rss}$			8		
<b>SWITCHING CHARACTERISTICS<sup>④</sup></b>						
Turn-on delay time	$t_{d(on)}$	$V_{GS} = -4.5V, V_{DS} = -10V,$ $I_D = -200mA, R_{GEN} = 10\Omega$		4.7		ns
Turn-on rise time	$t_r$			3.9		
Turn-off delay time	$t_{d(off)}$			88.3		
Turn-off fall time	$t_f$			47.8		

## Notes:

- Limited only by maximum temperature allowed.
- $P_W \leq 10\mu s$ . Limited only by maximum temperature allowed.
- Pulse Test : Pulse Width  $\leq 400\mu s$ , duty cycle  $\leq 2\%$ .
- Guaranteed by design, not subject to production.
- The value of  $R_{\theta JA}$  is measured with the device mounted on 1 in<sup>2</sup> FR-4 board with 2oz. single-sided Copper, in a still air environment with  $T_a = 25^{\circ}\text{C}$ .

# Typical Characteristics

Output Characteristics

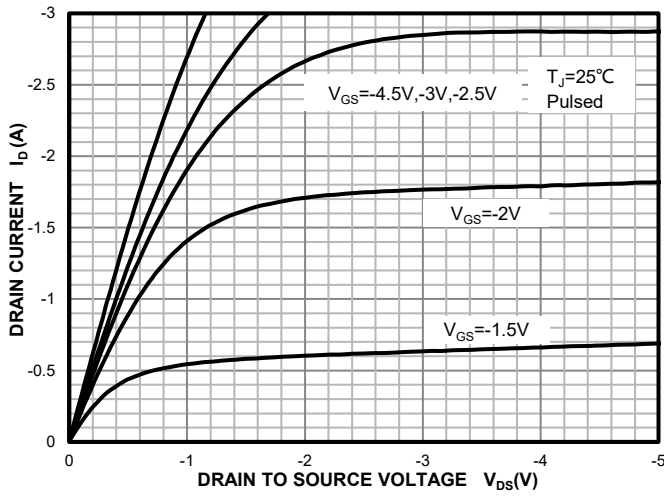

Transfer Characteristics

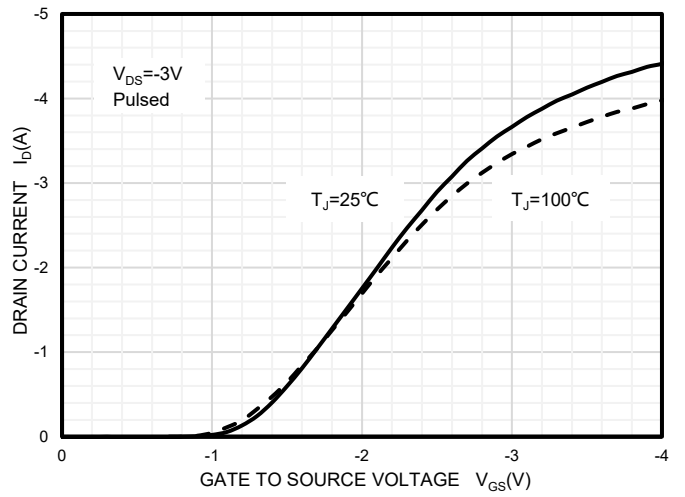

On Resistance vs. Drain Current

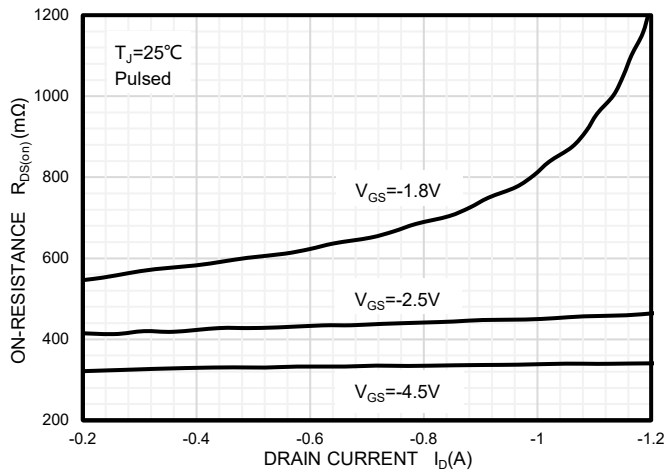

On Resistance vs. Gate-Source Bias

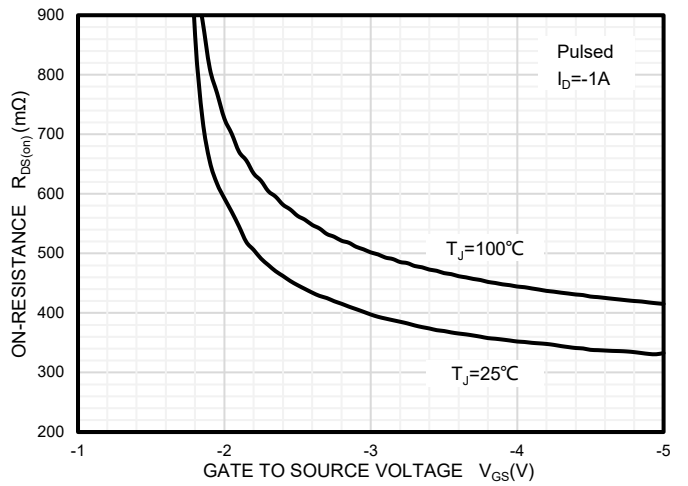

Source-Drain Diode Forward Characteristics

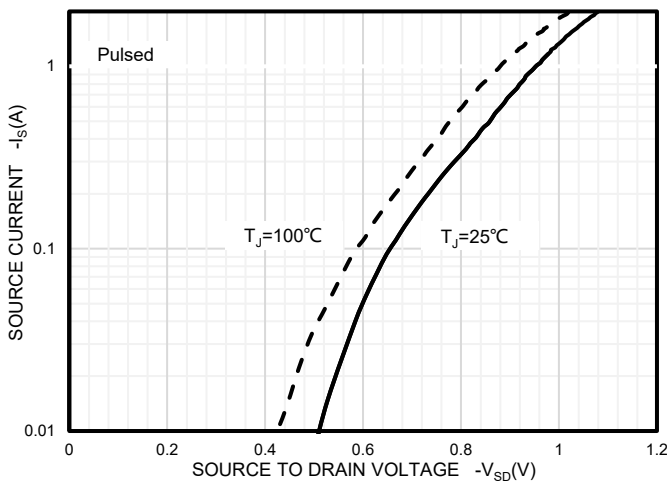

Threshold Voltage vs. Temperature

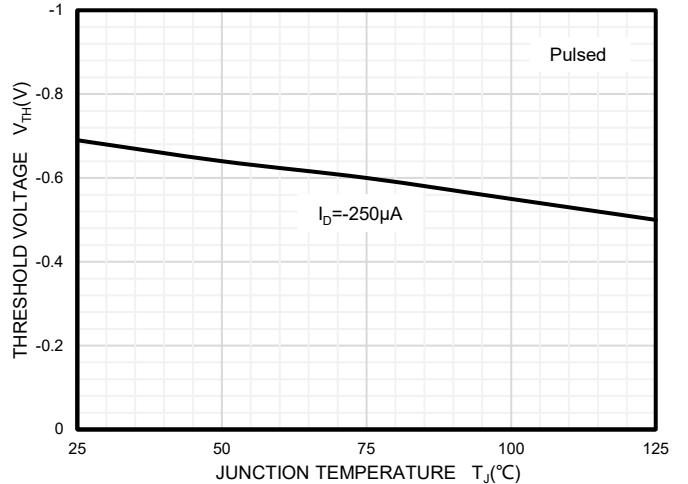

## SOT-23 Package Outline Dimensions

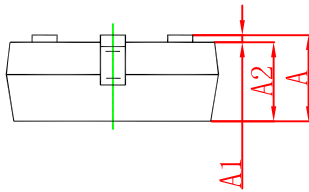
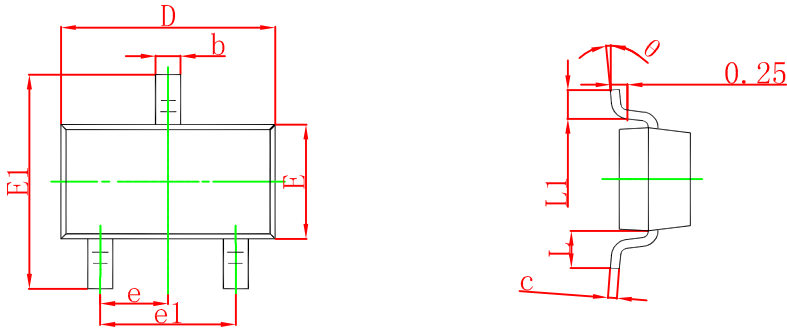

Symbol	Dimensions In Millimeters		Dimensions In Inches	
	Min	Max	Min	Max
A	0.900	1.150	0.035	0.045
A1	0.000	0.100	0.000	0.004
A2	0.900	1.050	0.035	0.041
b	0.300	0.500	0.012	0.020
c	0.080	0.150	0.003	0.006
D	2.800	3.000	0.110	0.118
E	1.200	1.400	0.047	0.055
E1	2.250	2.550	0.089	0.100
e	0.950 TYP		0.037 TYP	
e1	1.800	2.000	0.071	0.079
L	0.550 REF		0.022 REF	
L1	0.300	0.500	0.012	0.020
θ	0°	8°	0°	8°

## SOT-23 Suggested Pad Layout

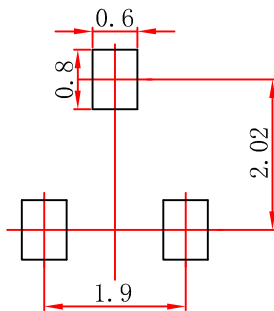

**Note:**

1. Controlling dimension: in millimeters.
2. General tolerance:  $\pm 0.05\text{mm}$ .
3. The pad layout is for reference purposes only.

**NOTICE**

JSCJ reserves the right to make modifications, enhancements, improvements, corrections or other changes without further notice to any product herein. JSCJ does not assume any liability arising out of the application or use of any product described herein.

# SOT-23 Tape and Reel

## SOT-23 Embossed Carrier Tape

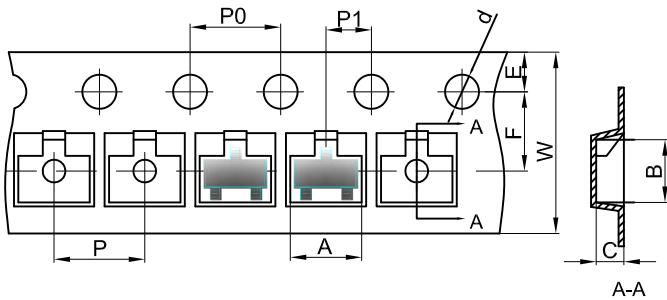

### Packaging Description:

SOT-23 parts are shipped in tape. The carrier tape is made from a dissipative (carbon filled) polycarbonate resin. The cover tape is a multilayer film (Heat Activated Adhesive in nature) primarily composed of polyester film, adhesive layer, sealant, and anti-static sprayed agent. These reeled parts in standard option are shipped with 3,000 units per 7" or 17.8cm diameter reel. The reels are clear in color and is made of polystyrene plastic (anti-static coated).

Dimensions are in millimeter

Pkg type	A	B	C	d	E	F	P0	P	P1	W
SOT-23	3.15	2.77	1.22	Ø1.50	1.75	3.50	4.00	4.00	2.00	8.00

## SOT-23 Tape Leader and Trailer

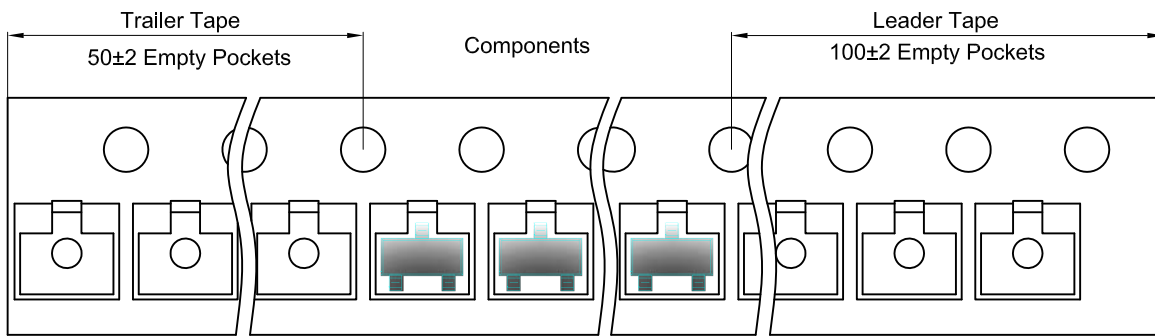

## SOT-23 Reel

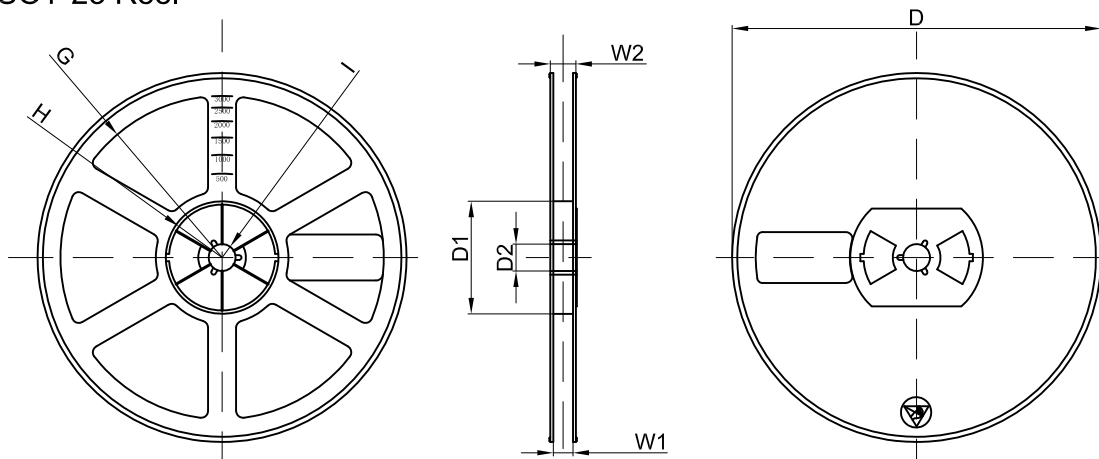

Dimensions are in millimeter

Reel Option	D	D1	D2	G	H	I	W1	W2
7"Dia	Ø178.00	54.40	13.00	R78.00	R25.60	R6.50	9.50	12.30

REEL	Reel Size	Box	Box Size(mm)	Carton	Carton Size(mm)	G.W.(kg)
3000 pcs	7 inch	45,000 pcs	203×203×195	180,000 pcs	438×438×220	