

# TO-277 Plastic-Encapsulate Diodes

## SP1060L Schottky Rectifier Diode

### Features

- $I_{F(AV)}$  10A
- $V_{RRM}$  60V
- High surge current capability
- Low peak forward voltage

### Applications

- Rectifier

### Marking

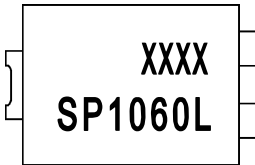

XXXX=code  
SP1060L=Device code

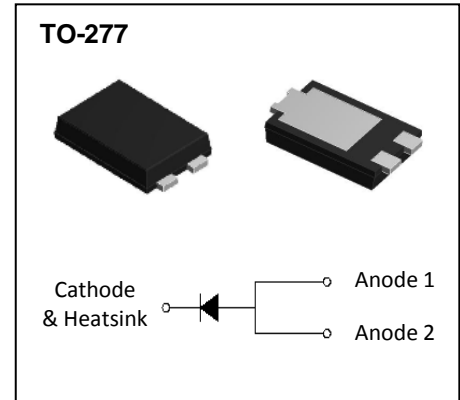

### Limiting Values(Absolute Maximum Rating)

| Item                                 | Symbol      | Unit             | Test Conditions   | SP1060L    |
|--------------------------------------|-------------|------------------|---|------------|
| Repetitive Peak Reverse Voltage      | $V_{RRM}$   | V                |   | 60         |
| Maximum RMS Voltage                  | $V_{RMS}$   | V                |   | 42         |
| Average Forward Current              | $I_{F(AV)}$ | A                | 60Hz Half-sine wave, Resistance load, $T_a=125^\circ\text{C}$ | 10         |
| Surge(Non-repetitive)Forward Current | $I_{FSM}$   | A                | 60Hz Half-sine wave, 1 cycle, $T_a=25^\circ\text{C}$          | 280        |
| Junction Temperature                 | $T_J$       | $^\circ\text{C}$ |   | -55 ~ +150 |
| Storage Temperature                  | $T_{STG}$   | $^\circ\text{C}$ |   | -55 ~ +150 |

### Electrical Characteristics ( $T=25^\circ\text{C}$ Unless otherwise specified)

| Item                         | Symbol           | Unit                      | Test Condition                     | SP1060L                 |                     |
|------------------------------|------------------|---------------------------|------------------------------------|-------------------------|---------------------|
| Peak Forward Voltage         | $V_F$            | V                         | $I_F=10.0A$                        | $T_a=25^\circ\text{C}$  | 0.47(TYP) 0.52(MAX) |
|                              |                  |                           |                                    | $T_a=125^\circ\text{C}$ | 0.40(TYP) 0.43(MAX) |
| Peak Reverse Current         | $I_{RRM1}$       | mA                        | $V_{RM}=V_{RRM}$                   | $T_a=25^\circ\text{C}$  | 0.08(TYP) 0.30(MAX) |
|                              | $I_{RRM2}$       |                           |                                    | $T_a=125^\circ\text{C}$ | 35(TYP) 40(MAX)     |
| Thermal Resistance(Typical)  | $R_{\theta J-A}$ | $^\circ\text{C}/\text{W}$ | Between junction and ambient       | 80                      |                     |
|                              | $R_{\theta J-L}$ |                           | Between junction and terminal      | 25                      |                     |
| Typical junction capacitance | $C_J$            | nF                        | $V_R=4.0\text{ V}, f=1\text{ MHz}$ | 0.95                    |                     |

### Notes:

Thermal resistance from junction to ambient and from junction to lead mounted on P.C.B. with 0.3" x 0.3" (8.0 mm x 8.0 mm) copper pad areas

# Typical Characteristics

FIG.1: FORWARD CURRENT DERATING CURVE

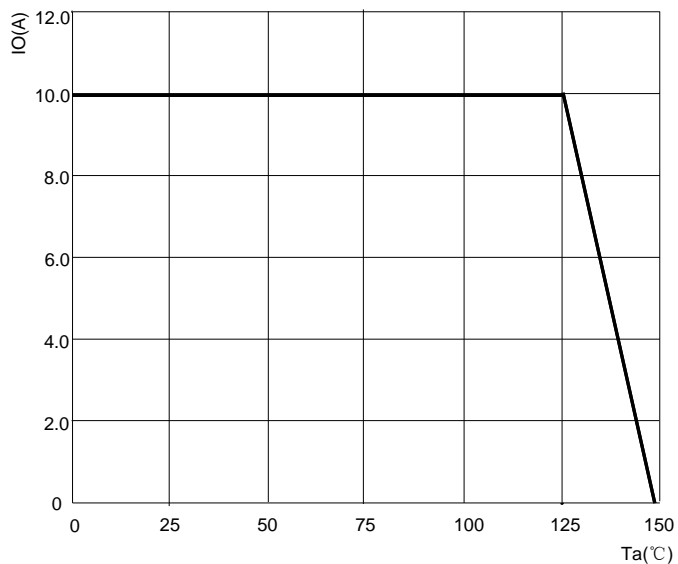

FIG.2: MAXIMUM NON-REPETITIVE FORWARD SURGE CURRENT

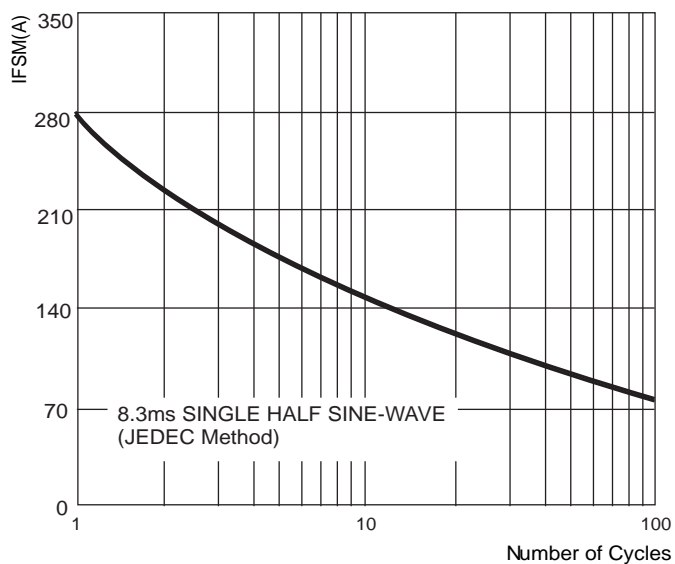

FIG.3: INSTANTANEOUS FORWARD CHARACTERISTICS

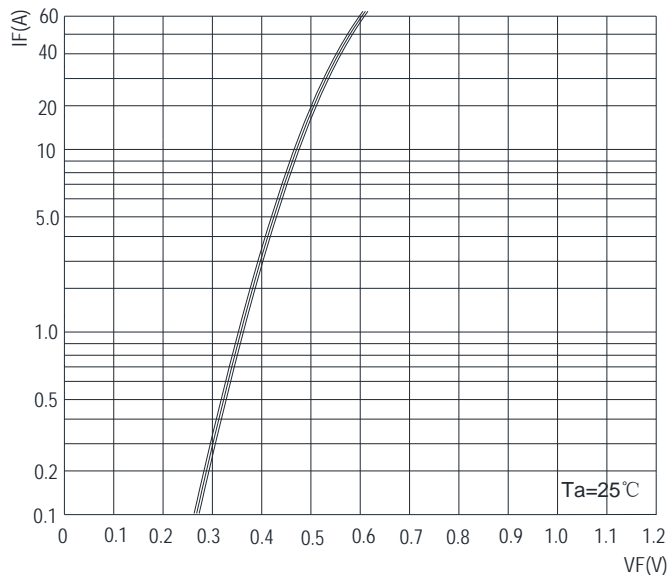
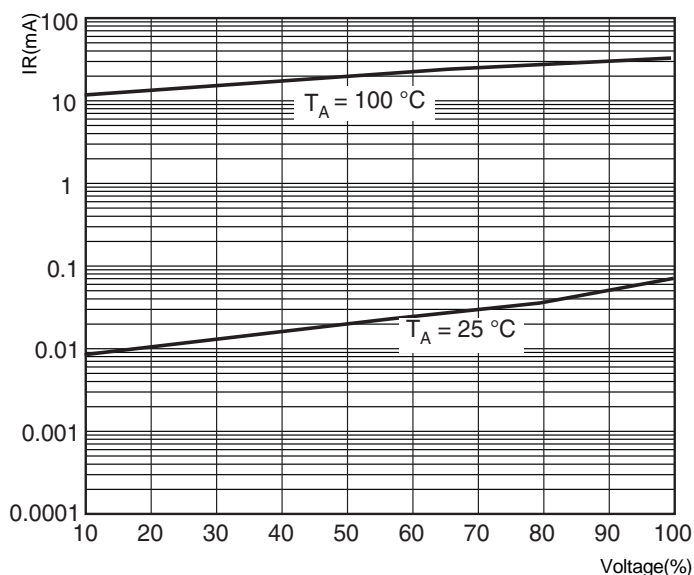
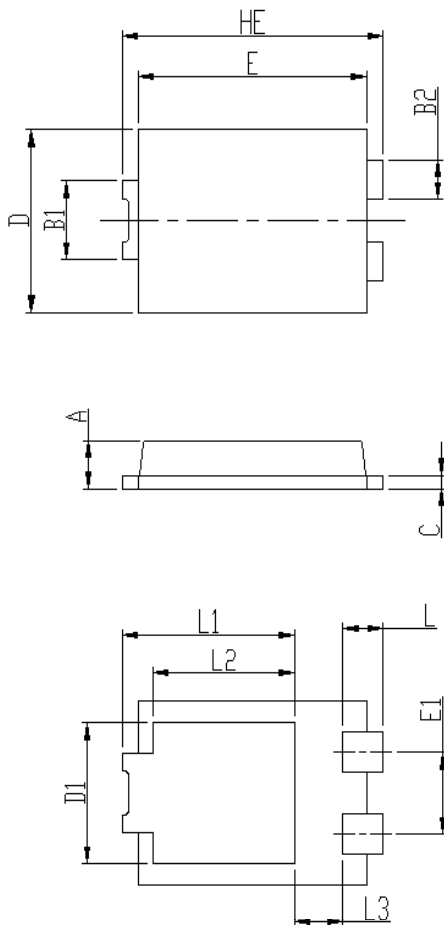

FIG.4: TYPICAL REVERSE CHARACTERISTICS



## TO- 277 Package Outline Dimensions



| DIM | Unit: mm  |     | Unit: inch |       |
|-----|-----------|-----|------------|-------|
|     | MIN       | MAX | MIN        | MAX   |
| HE  | 6.4       | 6.6 | 0.252      | 0.260 |
| E   | 5.6       | 5.8 | 0.220      | 0.228 |
| D   | 4.1       | 4.3 | 0.161      | 0.169 |
| B1  | 1.7       | 1.9 | 0.067      | 0.075 |
| B2  | 0.8       | 1   | 0.031      | 0.039 |
| A   | 1.05      | 1.2 | 0.041      | 0.047 |
| C   | 0.3       | 0.4 | 0.012      | 0.016 |
| L   | 0.85      | 1.1 | 0.033      | 0.043 |
| L1  | 4.2       | 4.4 | 0.165      | 0.173 |
| L2  | 3.52 Typ. |     | 0.139 Typ. |       |
| L3  | 1.1       | 1.4 | 0.043      | 0.055 |
| D1  | 3         | 3.3 | 0.118      | 0.130 |
| E1  | 1.86 Typ. |     | 0.073 Typ. |       |

## TO- 277 Suggested Pad Layout

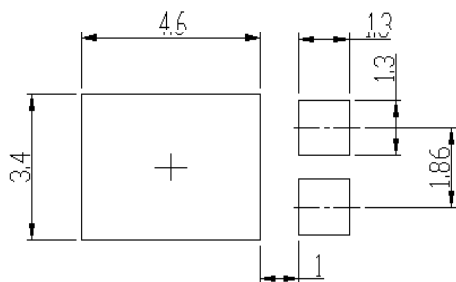

### Note:

1. Controlling dimension: in millimeters.
2. General tolerance:  $\pm 0.05$  mm.
3. The pad layout is for reference purposes only.

### NOTICE

JSCJ reserves the right to make modifications, enhancements, improvements, corrections or other changes without further notice to any product herein. JSCJ does not assume any liability arising out of the application or use of any product described herein.